

**C12X25 STRINGER (#3.1)**  
SCALE: 1 1/2" = 1'-0"

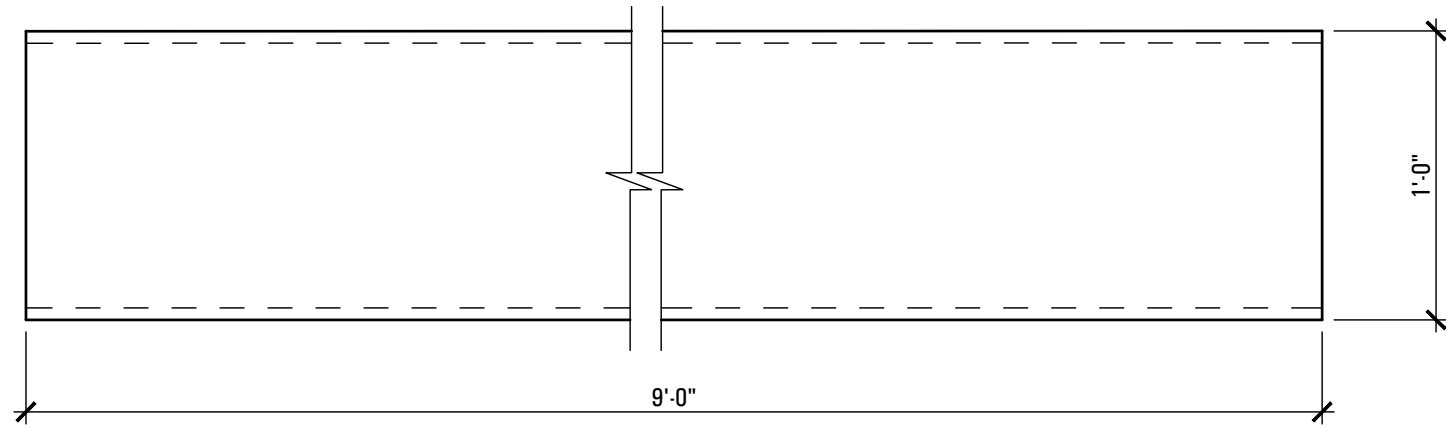

**C12X25 BEAM (#3.12)**  
SCALE: 1 1/2" = 1'-0"

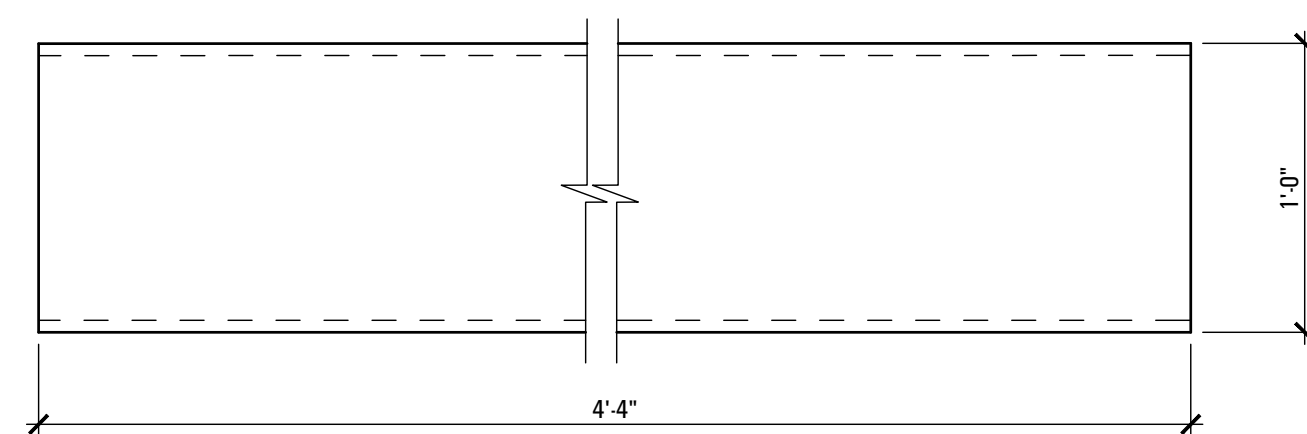

**C12X25 BEAM (#3.18)**  
SCALE: 1 1/2" = 1'-0"

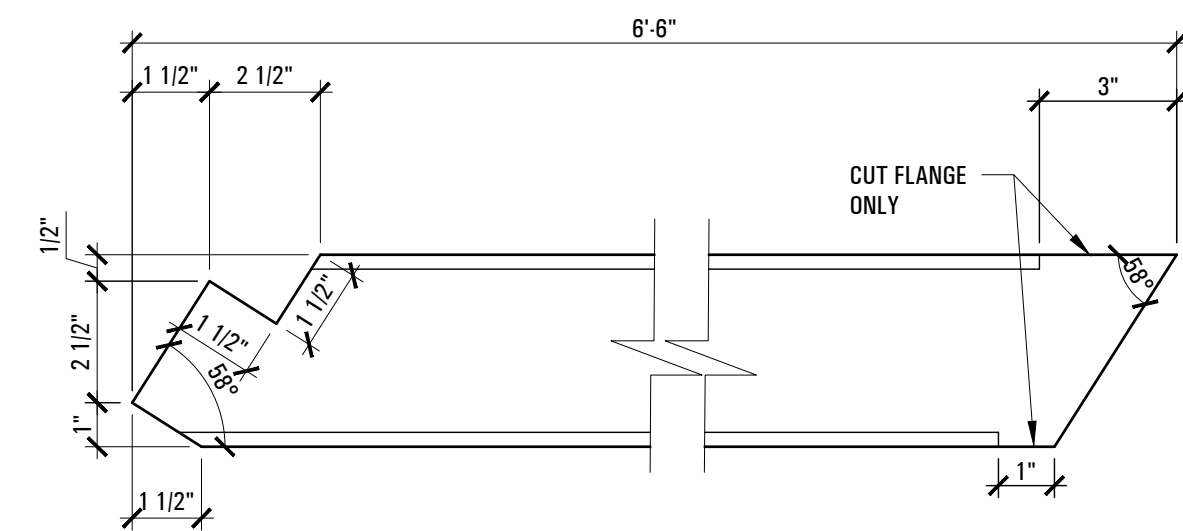

**C4X6.25 BEAM (#3.29)**  
SCALE: 3" = 1'-0"

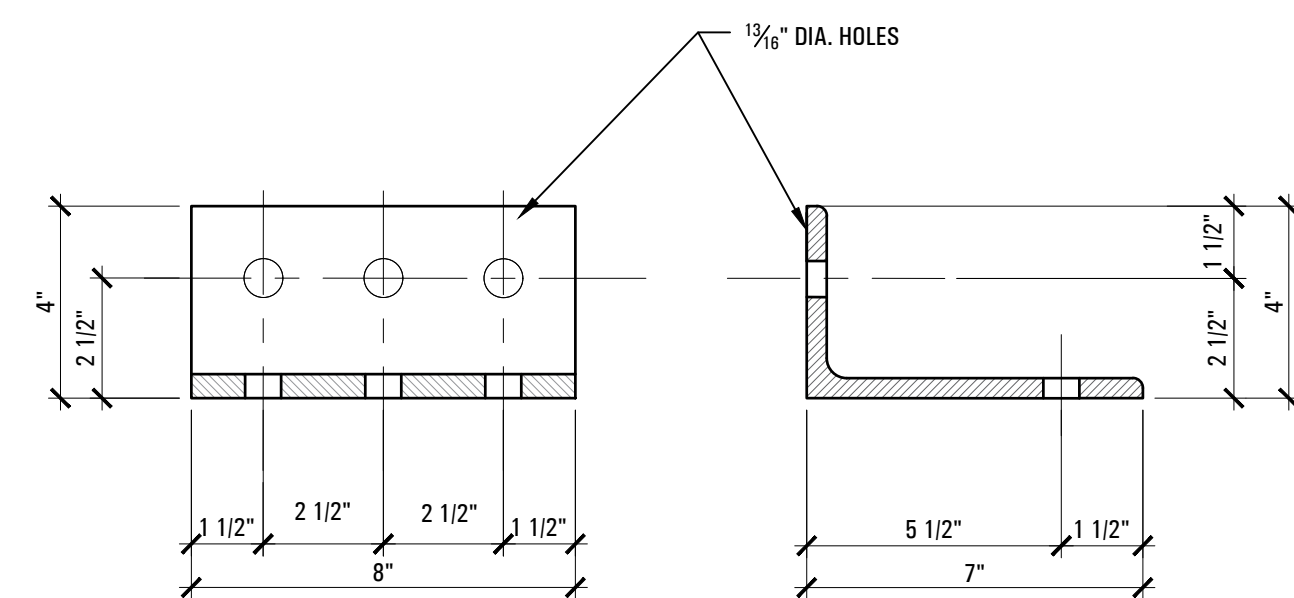

**L 7x4x1/2" CLIP ANGLE (#3.32)**  
SCALE: 3" = 1'-0"

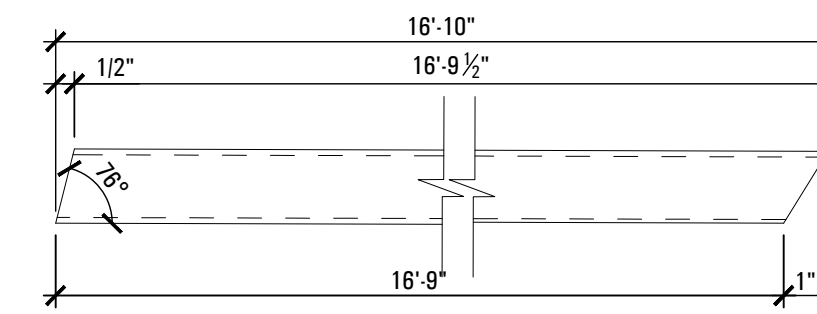

**1 1/2" Ø METAL HAND RAIL (#3.8)**  
SCALE: 3" = 1'-0"

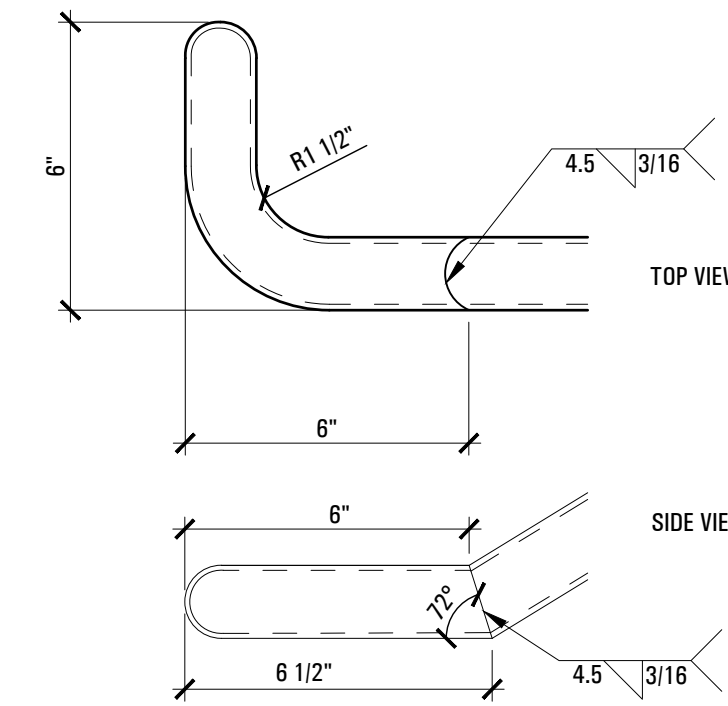

**1 1/2" Ø METAL HAND RAIL (#3.9)**  
SCALE: 3" = 1'-0"

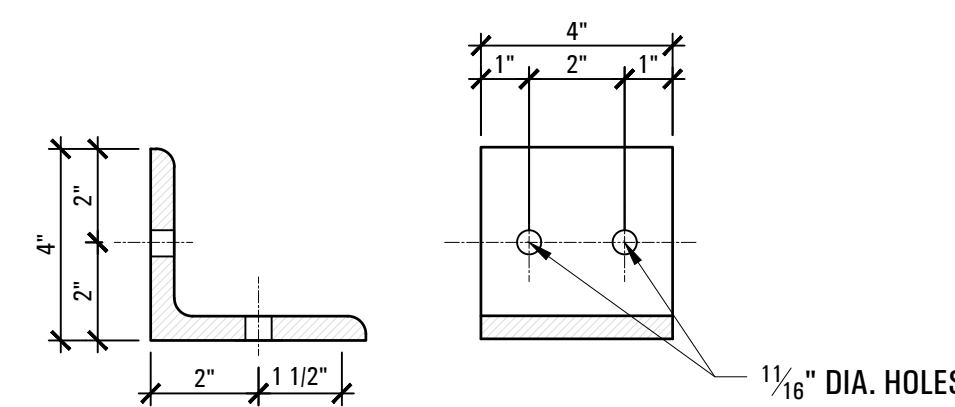

**L 4x4x1/2" CLIP ANGLE (#3.10)**  
SCALE: 3" = 1'-0"

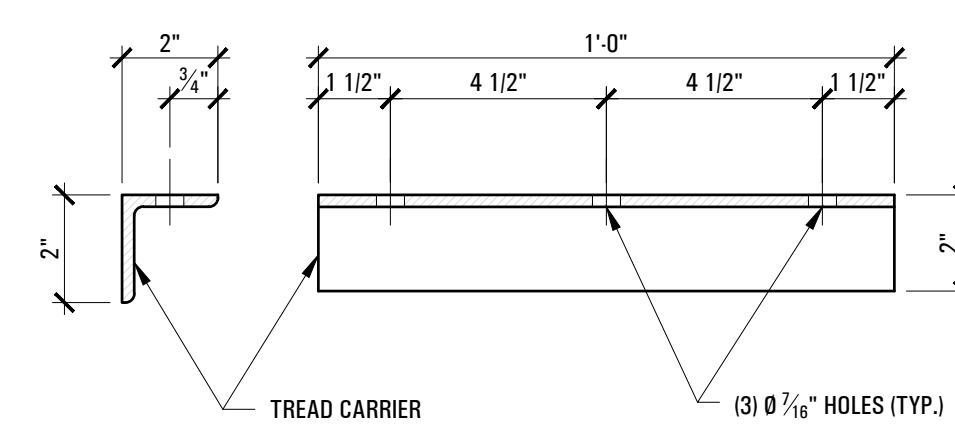

**L2x2x1/4" (#3.15)**  
SCALE: 3" = 1'-0"

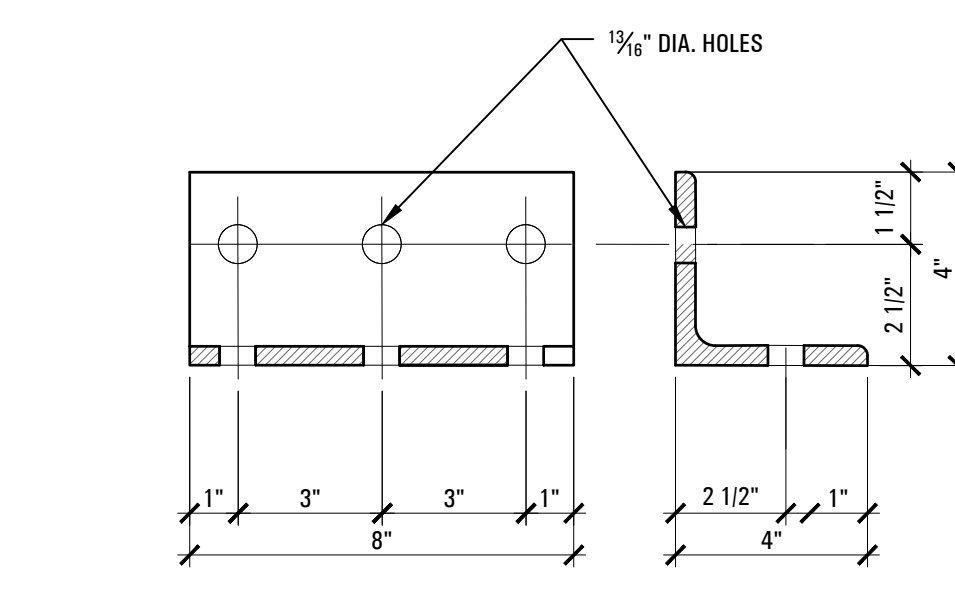

**L 4x4x3/8" CLIP ANGLE (#3.33)**  
SCALE: 3" = 1'-0"

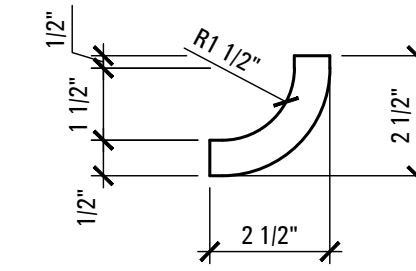

**1/2" DIA. BRACKET (#3.14)**

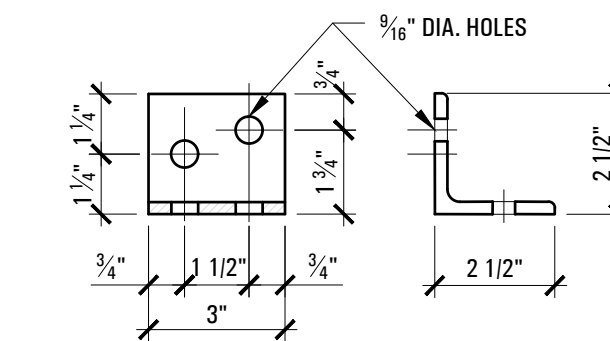

**L 2 1/2x2 1/2x1/4" CLIP ANGLE (#3.35)**  
SCALE: 3" = 1'-0"

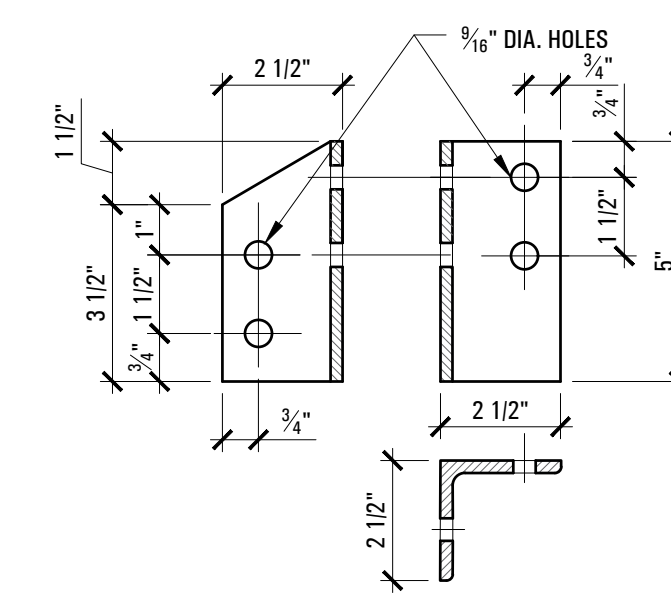

**L 2 1/2x2 1/2x1/4" CLIP ANGLE (#3.36)**  
SCALE: 3" = 1'-0"

STAIR 3.PART LIST			
3.1	C12X25 STRINGER	18'-4"	2 SYMMETRICAL
3.2	2 1/2" SQ. POST	9'-0"	2
3.3	2 1/2" SQ. POST	3'-11"	6
3.4	2 1/2" SQ. POST	4'-2"	2
3.5	1 1/2" SQ. METAL TOP RAILING	18'-7 1/2"	2
3.6	1 1/2" SQ. METAL BOTTOM RAILING	18'-7 1/2"	2
3.7	1 1/2" 11 GAUGE BALUSTERS	3'-3 3/4"	72
3.8	1 1/2" Ø XH PIPE METAL HAND RAIL	16'-10"	2 SYMMETRICAL
3.9	1 1/2" Ø XH PIPE METAL HAND RAIL	1'-0"	2 SYMMETRICAL
3.10	4X4X1/2 STEEL CLIP ANGLE	0'-4"	2
3.11	1" SQ. TUBE 11 GA	4'-0"	20
3.12	C12X25 BEAM	9'-0"	3
3.13	2"x2"x1/4" STEEL PLATE	-	12
3.14	1/2" BEND BRACKET AT EACH POST	0'-6"	12
3.15	L2x2x1/4" TREAD CARRIER	1'-0"	34
METAL BAR GRATING TREADS			
3.16	1 1/4" BEARING BAR X 3/16" THICK (4" O.C.) W/ NON-SLIP NOSING	1'-0" X 4'-0"	17
METAL BAR GRATING LANDING			
3.17	1 1/4" BEARING BAR X 3/16" THICK (4" O.C.) W/ NON-SLIP NOSING	9'-0" X 7'-2 1/2"	1
3.18	C12X25 BEAM	7'-1 1/2"	1
3.19	HSS 4" X 4" X 3/16" COLUMN	35'-11"	1
3.20	HSS 4" X 4" X 3/16" COLUMN	25'-5"	1
3.21	6" X 6" X 1/2" STEEL PLATE	-	4
3.22	HSS 4" X 4" X 3/16" COLUMN	31'-10"	1
3.23	12X12X1/2" STEEL PLATE	-	4
3.24	HSS 4" X 4" X 3/16" COLUMN	44'-3"	1
3.25	METAL PITCH POCKET SET	-	4
3.26	18" LONG FLASHING SHEET	-	4
3.27	POURABLE SEALER	-	4
3.28	PL 2X12X 1/2"	-	34
3.29	C4X6.25	6'-6"	2
3.30	C4X6.25	4'-6"	2
3.31	C4X6.25	-	4
3.32	7X4X1/2 STEEL CLIP ANGLE	0'-8"	2
3.33	4X4X3/8 STEEL CLIP ANGLE	0'-8"	6
3.34	5X3X1/2 STEEL CLIP ANGLE	0'-8"	3
3.35	2 1/2X2 1/2X1/4" STEEL CLIP ANGLE	0'-3"	2
3.36	2 1/2X2 1/2X1/4" STEEL CLIP ANGLE	0'-5"	2

SEAL

ELMECH Industrial Services LLC.  
Residential and Commercial Design  
3120 Lakewood Manor Dr.,  
Finksburg, MD 21048  
410-530-5364

STAIRS SHOP DRAWINGS  
144 WEST 15TH ST. NEW YORK, NY

MARK DATE DESCRIPTION

ISSUE:

PROJECT NO:

CAD FILE:

DATE:

DRAWN BY:

CHECKED BY:

COPYRIGHT:

SHEET TITLE:

STAIRS 3. PARTS

DRAWING SHEET NO:

**S008**



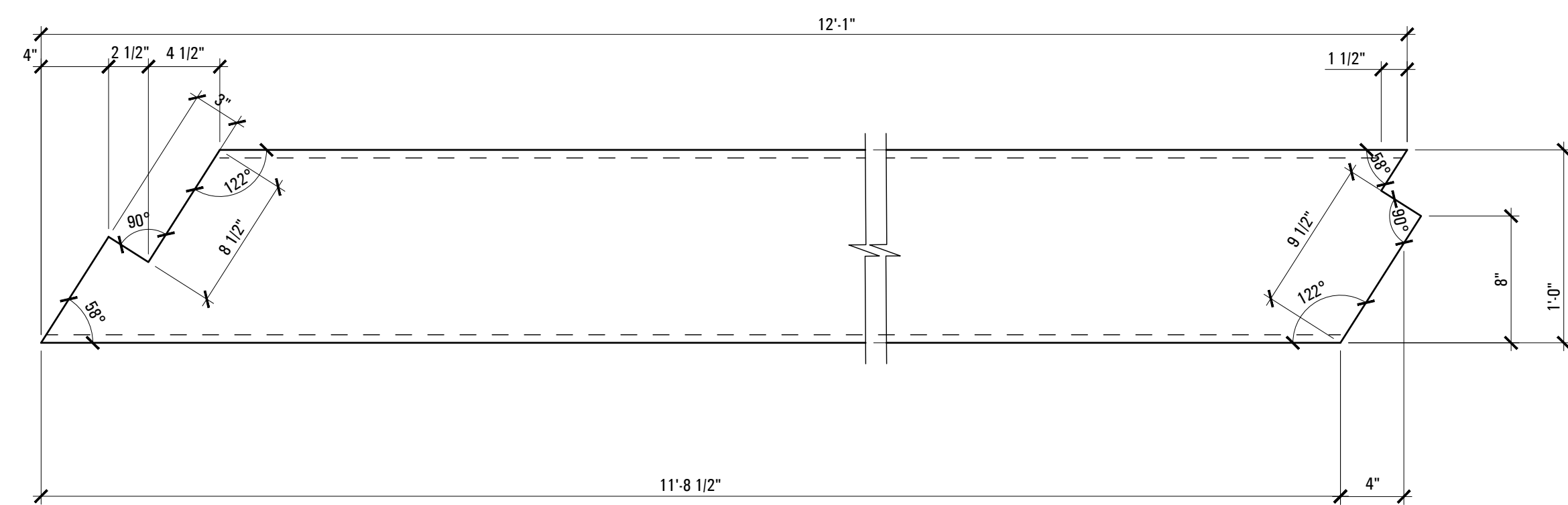

**C12X25 STRINGER (#5.1)**  
SCALE: 1 1/2" = 1'-0"

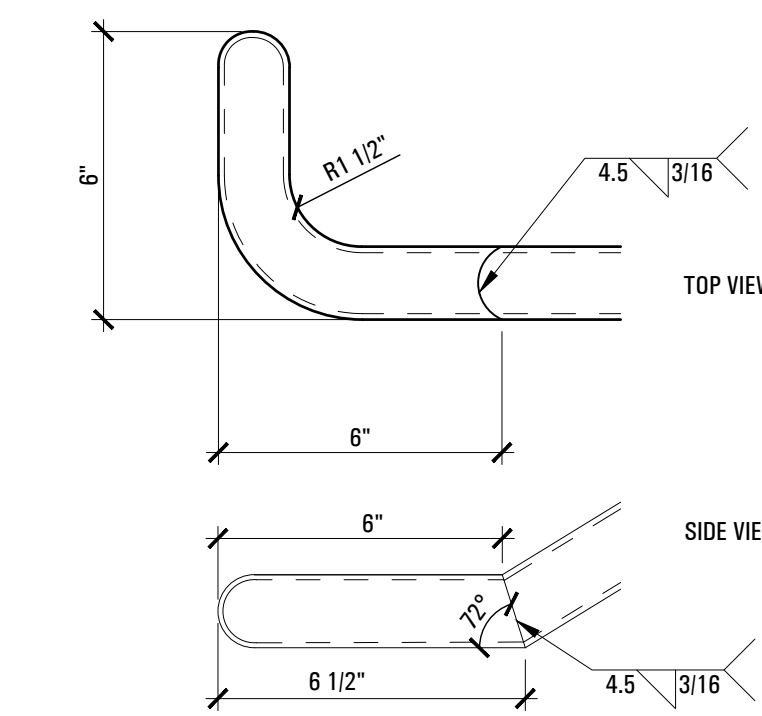

**1 1/2" Ø METAL HAND RAIL (#5.18)**  
SCALE: 3" = 1'-0"

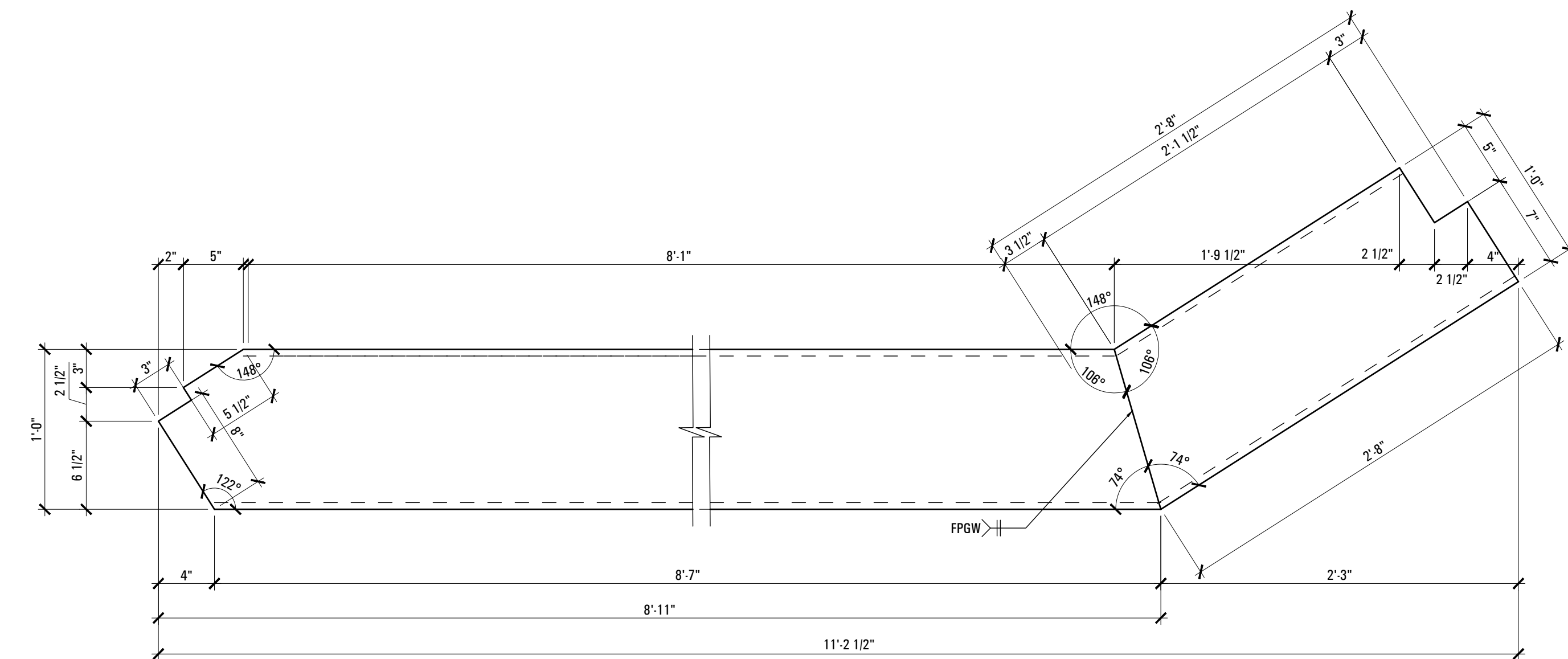

**C12X25 STRINGER (#5.2)**  
SCALE: 1 1/2" = 1'-0"

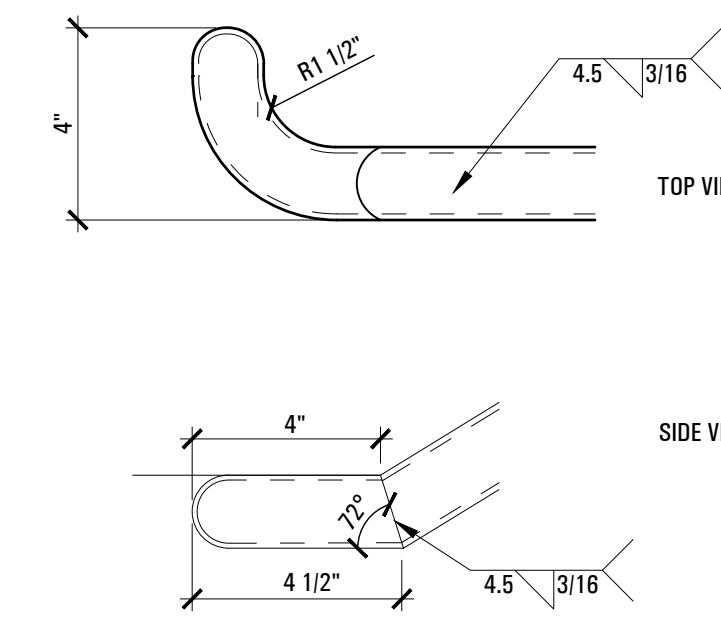

**1 1/2" Ø METAL HAND RAIL (#5.19)**  
SCALE: 3" = 1'-0"

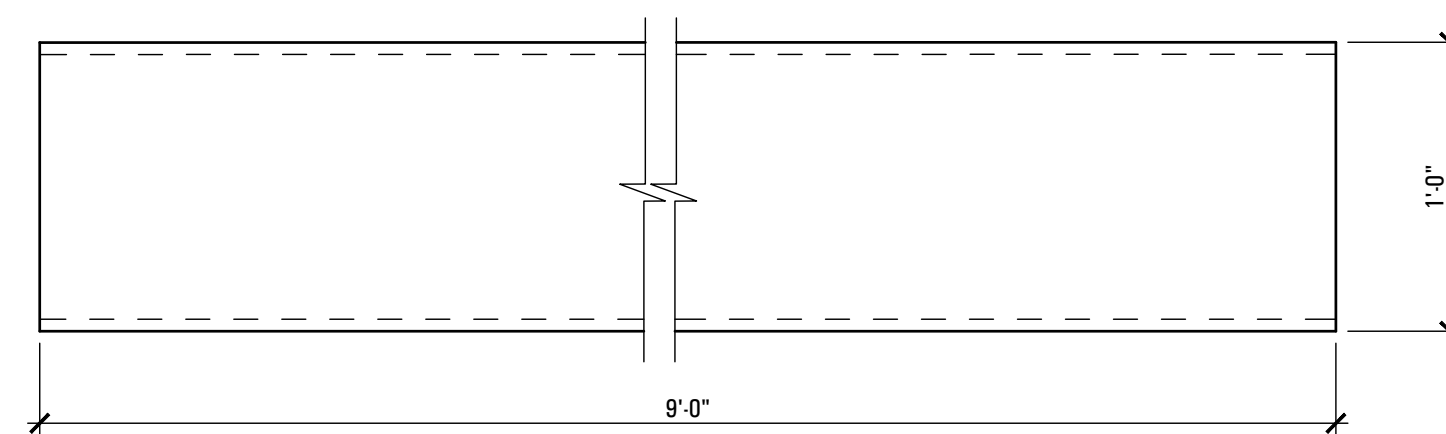

**C12X25 BEAM (#5.23)**  
SCALE: 1 1/2" = 1'-0"

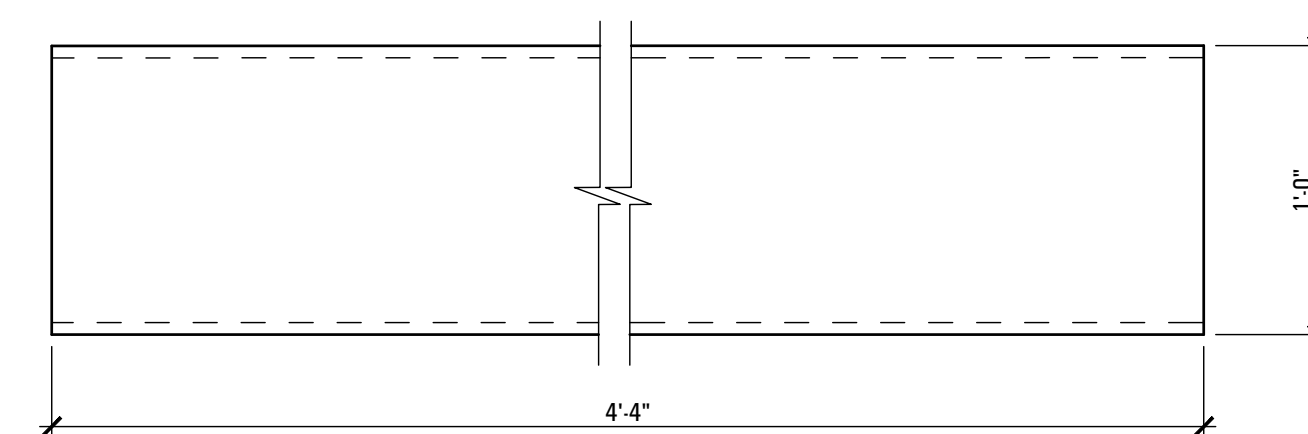

**C12X25 LEDGER (#5.25)**  
SCALE: 1 1/2" = 1'-0"

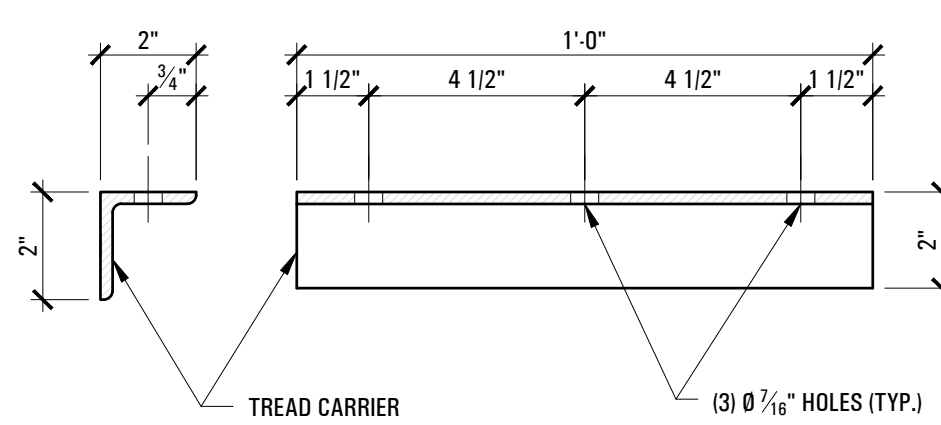

**L2x2x1/4" (#5.26)**  
SCALE: 3" = 1'-0"

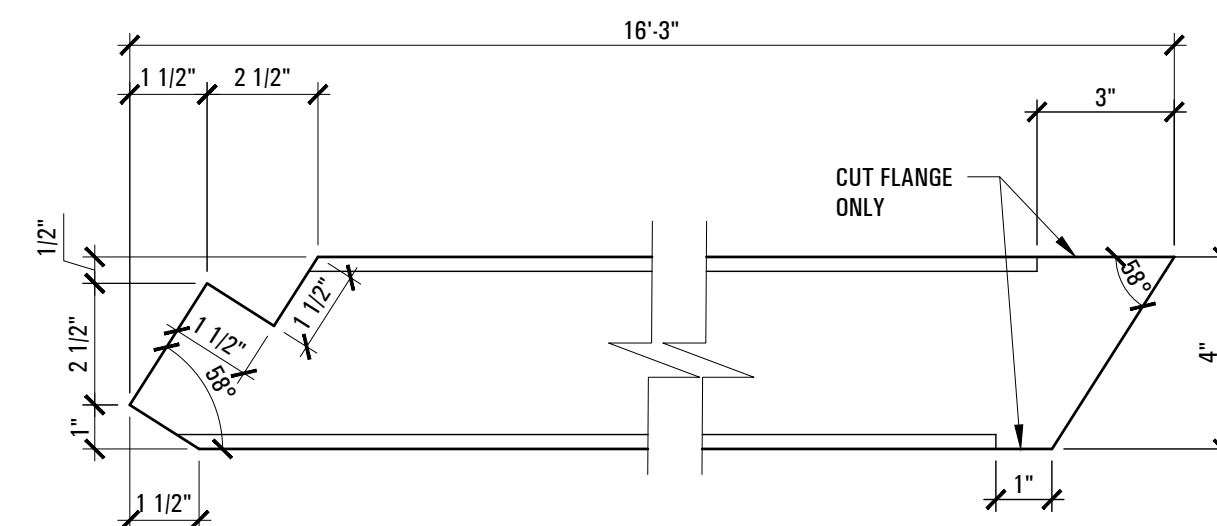

**C4X6.25 (#5.33)**  
SCALE: 3" = 1'-0"

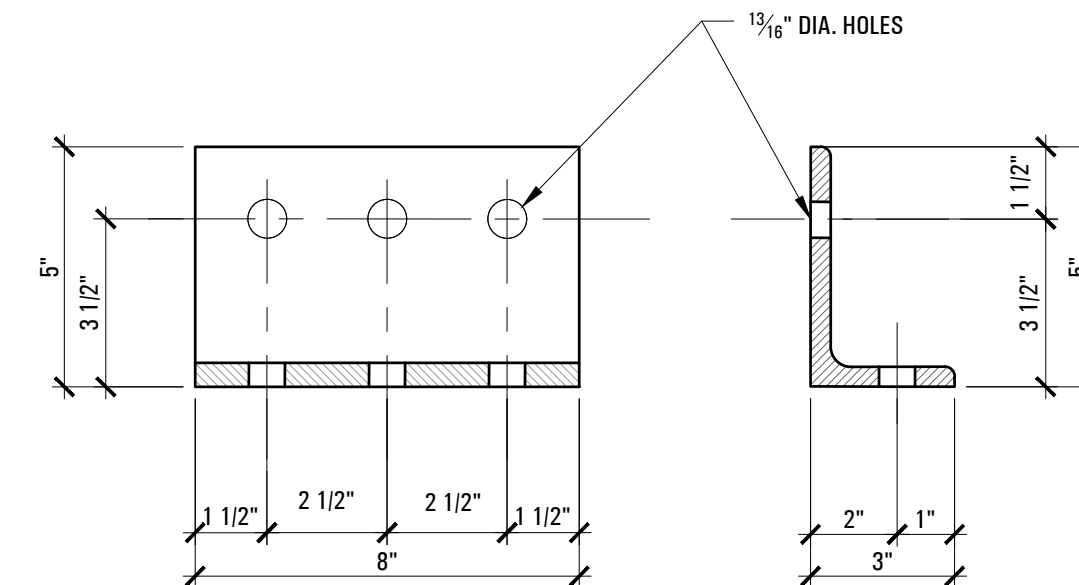

**L5x3x1/2" (#5.34)**  
SCALE: 3" = 1'-0"

STAIRS 6 & 7. PART LIST			
5.1	C12X25 STRINGER	12'-1"	2 SYMMETRICAL
5.2	C12X25 STRINGER	11'-3"	2 SYMMETRICAL
5.3	2 1/2" SQ. POST	4'-2 1/2"	9
5.4	2 1/2" SQ. POST	3'-11 1/2"	2
5.5	2 1/2" SQ. POST	4'-3 1/2"	2
5.6	2 1/2" SQ. POST	4'-0"	1
5.7	1 1/2" SQ. METAL TOP RAILING	10'-11 1/2"	1
5.8	1 1/2" SQ. METAL TOP RAILING	8'-4"	1
5.9	1 1/2" SQ. METAL TOP RAILING	4'-2"	4
5.10	1 1/2" SQ. METAL TOP RAILING	3'-9 1/2"	2
5.11	1 1/2" SQ. METAL BOTTOM RAILING	10'-11 1/2"	1
5.12	1 1/2" SQ. METAL BOTTOM RAILING	8'-4"	1
5.13	1 1/2" SQ. METAL BOTTOM RAILING	4'-2"	4
5.14	1 1/2" SQ. METAL BOTTOM RAILING	3'-9 1/2"	2
5.15	3/4" 11 GAUGE BALUSTERS	3'-3 3/4"	74
5.16	1 1/2" Ø XH PIPE METAL HAND RAIL	11'-3"	1
5.17	1 1/2" Ø XH PIPE METAL HAND RAIL	10'-1"	2 SYMMETRICAL
5.18	1 1/2" Ø XH PIPE METAL HAND RAIL	1'-0"	5 SYMMETRICAL
5.19	1 1/2" Ø XH PIPE METAL HAND RAIL	0'-10"	5 SYMMETRICAL
5.20	1 1/2" Ø XH PIPE METAL HAND RAIL	8'-2"	2 SYMMETRICAL
5.21	1" SQ. TUBE 11 GA	4'-0"	19
5.22	1/2" BEND BRACKET AT EACH POST	0'-6"	14
5.23	C12X25 BEAM	9'-0"	4
5.24	2"x2"x1/4" STEEL PLATE	-	14
5.25	C12X25 BEAM	4'-4"	4
5.26	L2X2X1/4" TREAD CARRIER	1'-0"	38
5.27	METAL BAR GRATING TREADS 1 1/4" BEARING BAR X 3/16" THICK (4" O.C.) WINDOW-SLIP NOSING	1'-0"X4'-0"	19
5.28	METAL BAR GRATING LANDING 1 1/4" BEARING BAR X 3/16" THICK (4" O.C.) WINDOW-SLIP NOSING	4'-4"X8'-6"	1
5.29	PL 3X6X 1/2"	-	8
5.30	PL 2X12X 1/4"	-	38
5.31	C4X6.25	9'-4"	2
5.32	C4X6.25	9'-3"	2
5.33	C4X6.25	16'-3"	2
5.34	5X3X1/2 STEEL CLIP ANGLE	0'-8"	4
5.35	2 1/2X2 1/2X1/4" STEEL CLIP ANGLE	0'-3"	10
5.36	2 1/2X2 1/2X1/4" STEEL CLIP ANGLE	0'-5"	2

**1" DIA. BRACKET (#5.22)**  
SCALE: 3" = 1'-0"

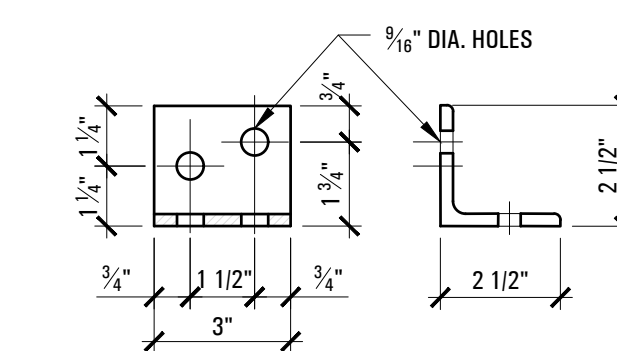

**L 2 1/2X2 1/2X1/4" CLIP ANGLE (#5.35)**  
SCALE: 3" = 1'-0"

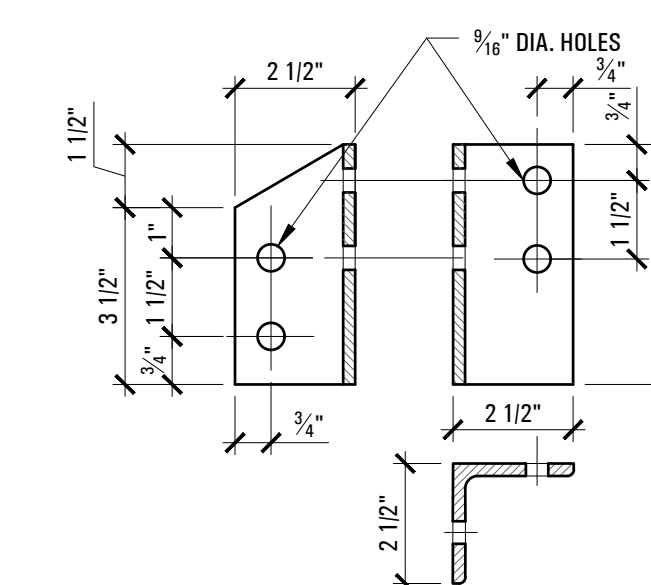

**L 2 1/2X2 1/2X1/4" CLIP ANGLE (#5.36)**  
SCALE: 3" = 1'-0"

SEAL

ELMECH Industrial Services LLC.  
Residential and Commercial Design  
3120 Lakewood Manor Dr.,  
Finksburg, MD 21048  
410-530-5364

STAIRS SHOP DRAWINGS  
144 WEST 15TH ST. NEW YORK, NY

MARK DATE DESCRIPTION

ISSUE:

PROJECT NO:

CAD FILE:

DATE:

DRAWN BY:

CHECKED BY:

COPYRIGHT:

SHEET TITLE:

STAIRS 6 & 7.  
PARTS

DRAWING SHEET NO:

S010